



seamless AN 18TH-CENTURY TOWNHOUSE GETS A LOFT-STYLE DESIGN

blending

WISH LIST

- Commercial ambience in work area
- Antique furnishings
- Minimal cabinetry

Boston architect Joseph Kennard likes to work with modern technology and materials, but he also likes to show respect for an existing home's original design and patina. Blending the two seamlessly requires a deft design sensibility. Kennard did so recently in a new kitchen for a couple who had moved into a duplex in an 18th-century Beacon Hill townhouse.

"I sought a balance between pieces and materials that were modern and old or looked old, so the overall feeling would be calm and you couldn't

tell when the kitchen was done," he says.

To make it functional and large enough to welcome the owners' friends and grown children, Kennard removed the wall between the kitchen and an adjacent sitting area, so it's now one large space with a fireplace. He also raised the ceiling 3' to 10'6", and replaced the floor, which was a combination of wood and tile, with one new oak floor stained to a dark walnut hue.

Although the wife frequently cooks, she was not interested in large-scale equipment and multiple pieces like many other amateur chefs now desire. Having previously lived in a New York City loft, she knew she could turn out large meals for friends and family, including for Thanksgiving, with small-scale appliances.

Choices made by the designer and clients included an undercabinet glass-fronted refrigerator, undercabinet stainless-steel freezer, one undercabinet oven, a two-burner cooktop on the counter and a large farmhouse-style sink that looks old but is new. Countertops are a practical gray epoxy resin, a new material popular in laboratories, which is stain-resistant and also doesn't cause items that are dropped to break.

By lining up equipment and most of the countertop space galley-style along one long wall, Kennard offered the owners another bonus: no extra footsteps.

The exception is a secondary work area in an adjacent corner, which consists of off-white painted wood cabinets, above and beneath a maple butcherblock countertop, with room for a standing mixer and microwave oven.

To create the eclectic feeling that wouldn't date the house from a single period and would give it its "uniquely refreshing" ambience, he says, there's the mix of the glass cabinets with metal frames, painted wooden drawers in orange, red and gray, and a number of handcrafted wooden designs by Boston artist Jess Smith.

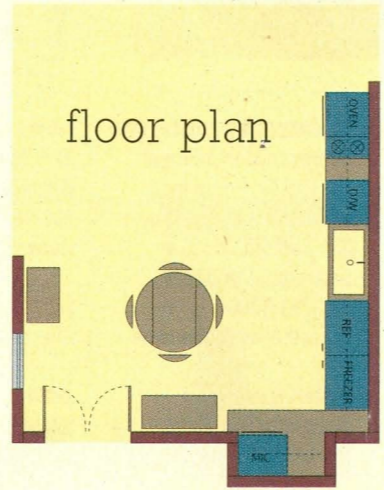

ARCHITECT:
Joseph Kennard
Joseph Kennard Architects
Inc.
49 Melcher St., No. 3D
Boston, MA 02210
617-292-8989

LOCATION:
Boston, MA

DIMENSIONS:
13'6" by 12'6" (to end of countertop in kitchen area)

BUILDER:
Finley Perry
F.H. Perry
90 Elm St.
Hopkinton, MA 01748
508-435-3062

SPECIAL FEATURES:
Metal-framed glass display cabinets; Stainless steel frames for appliances and structural details beneath countertop; Undercounter refrigerator and freezer

PRODUCTS:
Refrigerator: Summit
Freezer: Summit
Sink: Kohler
Faucet: KWC
Dishwasher: Miele
Cooktop and oven: Gaggenau
Microwave: GE
Custom-made wood shelves and cabinetry: Jess Smith
Glass display cases: M. Kabram & Sons

A mix of materials—stainless steel, colored wood, stained wood, glass and epoxy resin—give this kitchen its contemporary edginess, while antique touches like a pendant light reflect the home's historic style.

The main work area is mostly one galley-style work wall with open shelves and glass cabinets to free up the wall and give the room its industrial-style look.